

Mechanical Water Regulating Valve Hose Installation

For proper operation, the water regulating valve must be connected to the condenser. The water regulating valve uses the refrigerant pressure from the condenser to modulate the regulating valve and control the condenser water flow.

Connect hose assembly to condenser, as shown on Figure 1.

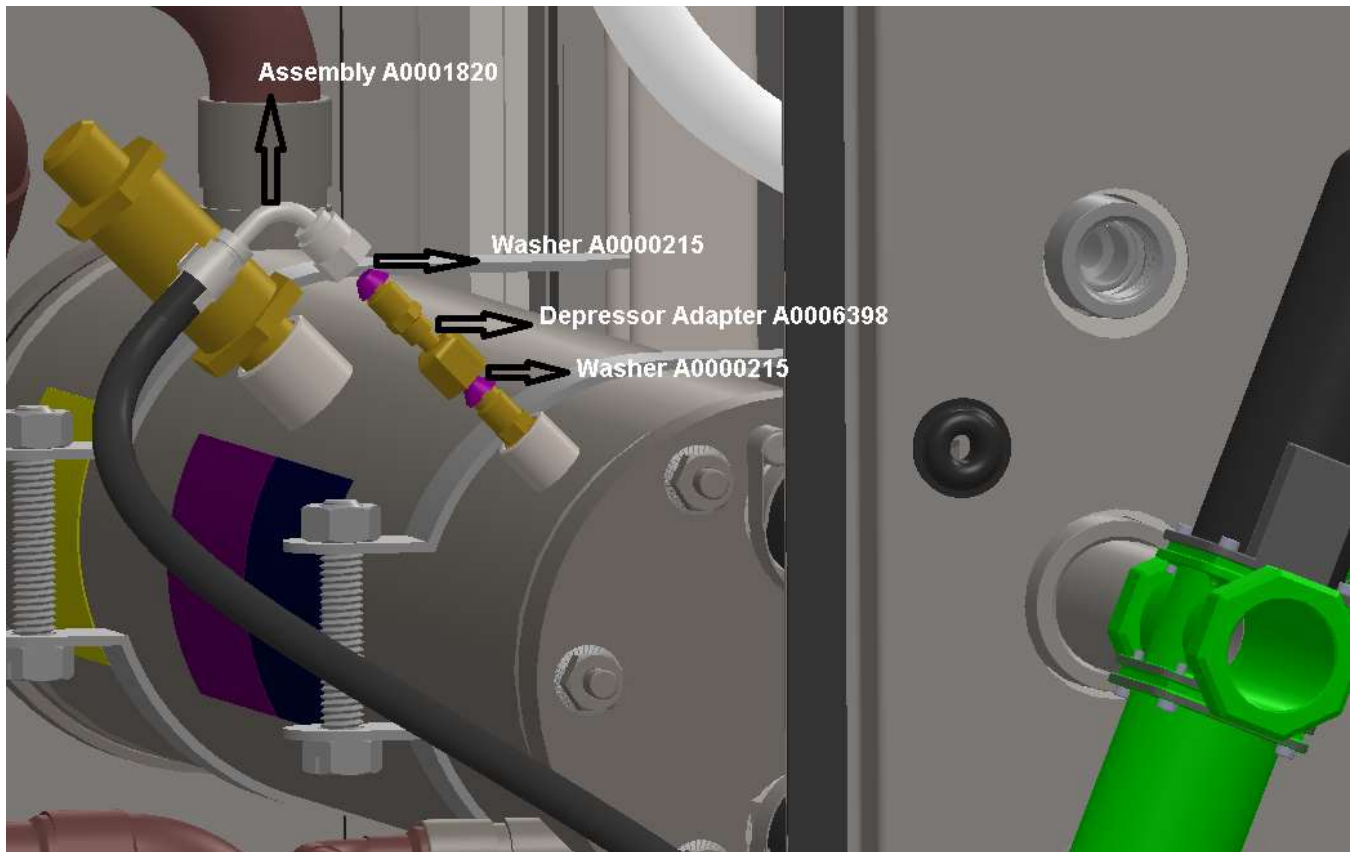

Figure 1

This assembly will contain:

- 1x Refrigeration Hose Assembly A0001820
- 6x Washers A0000215
- 1x Depressor Adapter A0006398
- 1x Water Regulating Valve A0006809

The quantities shown above are for each water regulating valve assembly.

INSTALLATION

1. Place the washer in one side of the Refrigeration Hose Assembly and attach it to the Water Regulating Valve per Figure 2. Place the washer in the other one side of the Refrigeration Hose Assembly and connect it to the Depressor Adapter per Figure 1.
2. Lastly, install the Depressor Adapter to the condenser.
3. Make sure to check for leaks after completing the installation.

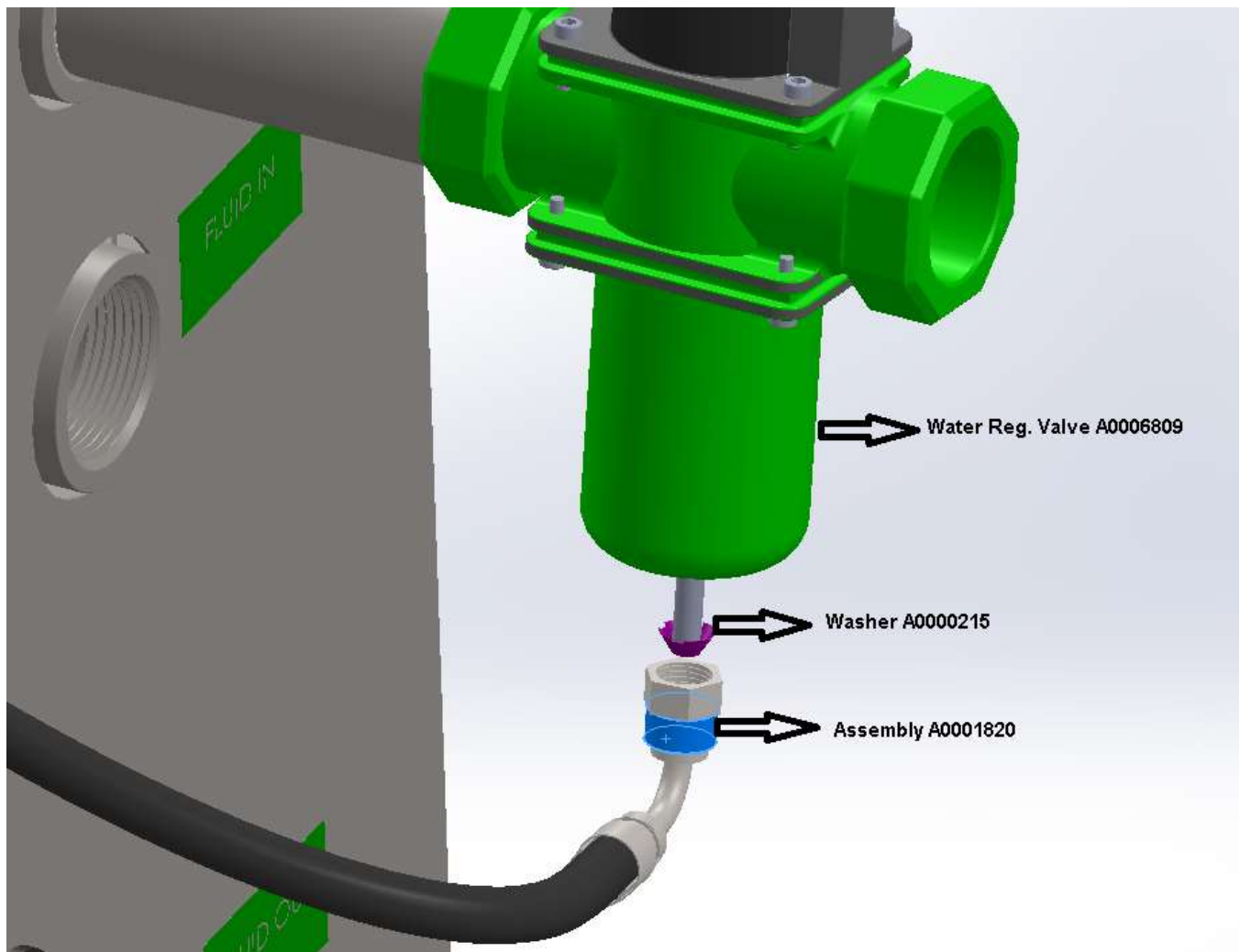

Figure 2