

INSTALLATION

!!! CAUTION !!!

Disconnect power supply before installation or maintenance. Failure to do so may result in equipment damage.

Make sure all connections are in accordance with the job wiring diagram and in accordance with national and local electrical codes. Use copper conductors only.

NOTICE

Use electrostatic discharge precautions (e.g., use of wrist straps) during installation and maintenance to prevent equipment damage. The sensor is particularly sensitive to electric shock.

Avoid locations where severe shock or vibration, excessive moisture, or corrosive fumes are present.

Do not exceed ratings of this device; permanent damage not covered by warranty may result. The 4-20 mA models are not designed for AC voltage operation.

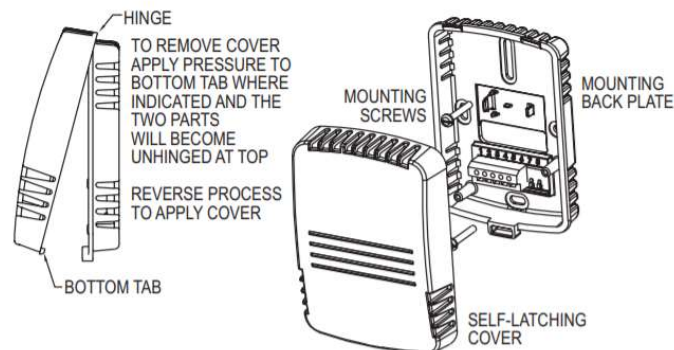

Figure 1

1. Push tab on bottom of cover and lift cover from back plate. (See Figure 1).
2. Select the mounting location, away from diffusers, lights, or any external influences.
 - Install sensor inside controlled ambient (temperature/humidity).
 - Mount on wall, approx. 5ft-6in from floor.
 - Make sure supply air does not blow across the sensor.
 - Install sensor in an area that is representative of the temperature of the air (away from heat sources, doors, etc.)
3. Mount transmitter on a vertical surface to a standard electrical box using the two #6 M2C type screws provided.
4. Pull wires through subbase hole and make necessary connections.
5. Reattach cover to base plate.

A0002238 Installation Instructions (Wall Mounted Temp/RH Sensor)

WIRING

Use maximum 18 AWG wire for wiring to terminals. Refer to figure bellow and page 1 of the AIR EF drawing for wiring information.

